

THE ROSLIN BEACH HOTEL

THORPE ESPLANADE, THORPE BAY,
ESSEX, SS1 3BG

Do not scale this drawing. Work to figured dimensions only. This drawing is copyright of APS Designs and should only be reproduced with their express permission. Check all dimensions on site. Any discrepancies should be reported to APS Designs prior to commencement.

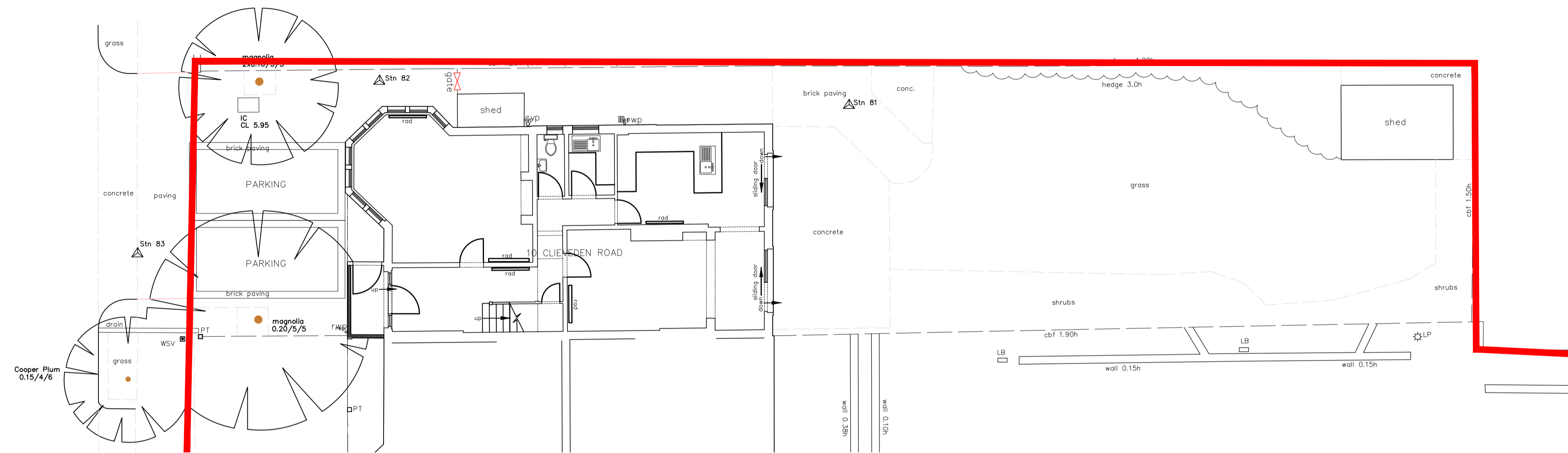

1 Existing Ground Floor Plan

Scale: 1:100

REV A | 20.10.2016 | Amendments made in line with invalid letter dated 19.10.2016
REVISION DATE AMENDMENT

APS DESIGN ASSOCIATES LTD
ARCHITECTURAL DESIGNERS AND PLANNING CONSULTANTS

PROJECT STAGE: TOWN PLANNING
DRAWN BY:
DATE: Sept 2016
CLIENT:

PROJECT: The Roslin Beach Hotel
JOB NO: 2421
DRAWING NO: 02
REVISION:

DRAWING TITLE: The Business Centre- Existing Ground Floor plan
SCALE: 1:100 @ A1

The Design Studio
1 Cambridge Road (Rear)
Nelson Street
Southend-On-Sea
Essex
SS1 1ET

Tel: 01702 469 769 - 01702 337328
Email: admin@apsdesignsuk.com
design@apsdesignsuk.com
planning@apsdesignsuk.com
Website: www.apsdesignsuk.com